

ANTI VIBRATION SANDWICH MOUNTS

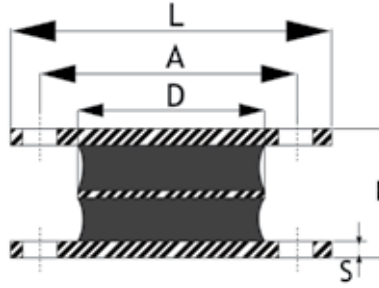

<p>Sandwich Mounts can be loaded in compression, shear or a combination of both by fitting at an angle.</p> <p>H= Height L = Length D= Diameter A= Hole Distance W = Flange Width F= Flange Length S= Metal Thickness</p>	<p>Applications:</p> <ul style="list-style-type: none"> • Engine mountings • Generator sets • Heavy plant & machinery. 	<p>Material: Natural Rubber</p>
---	--	--

Article No.	H (mm)	L (mm)	D (mm)	A (mm)	W (mm)	F (mm)	S (mm)	Maximum Load (kg)	Static Deflection (mm)
VSM406-45	36	90	54	74.5	40	6.8	3.5	95	2.8
VSM406-50								135	2.8
VSM406-60								200	2.8
VSM406-70								310	2.8
VSM322-45	43	110	64	89	57	11	5	190	3.0
VSM322-60								375	3.0
VSM322-70								500	2.6
VSM284-45	43	127	84	108	57	11	5	300	3.0
VSM284-60								600	3.0
VSM284-70								800	2.6
VSM242-45	43	168	127	146	57	11	5	450	3.0
VSM242-60								850	2.8
VSM242-70								1000	2.2
VSM30242-45	31	166	119	146	55	11	5	180	2.1
VSM30242-60								360	2.1
VSM30242-70								530	2.1

This information is for guidance only. Customers are recommended to contact us for further technical information on products and applications. We reserve the right to alter specifications or withdraw products without notice.